

▼
Creative Passion

Koino[®]

www.koino.com

TERMINAL BLOCKS

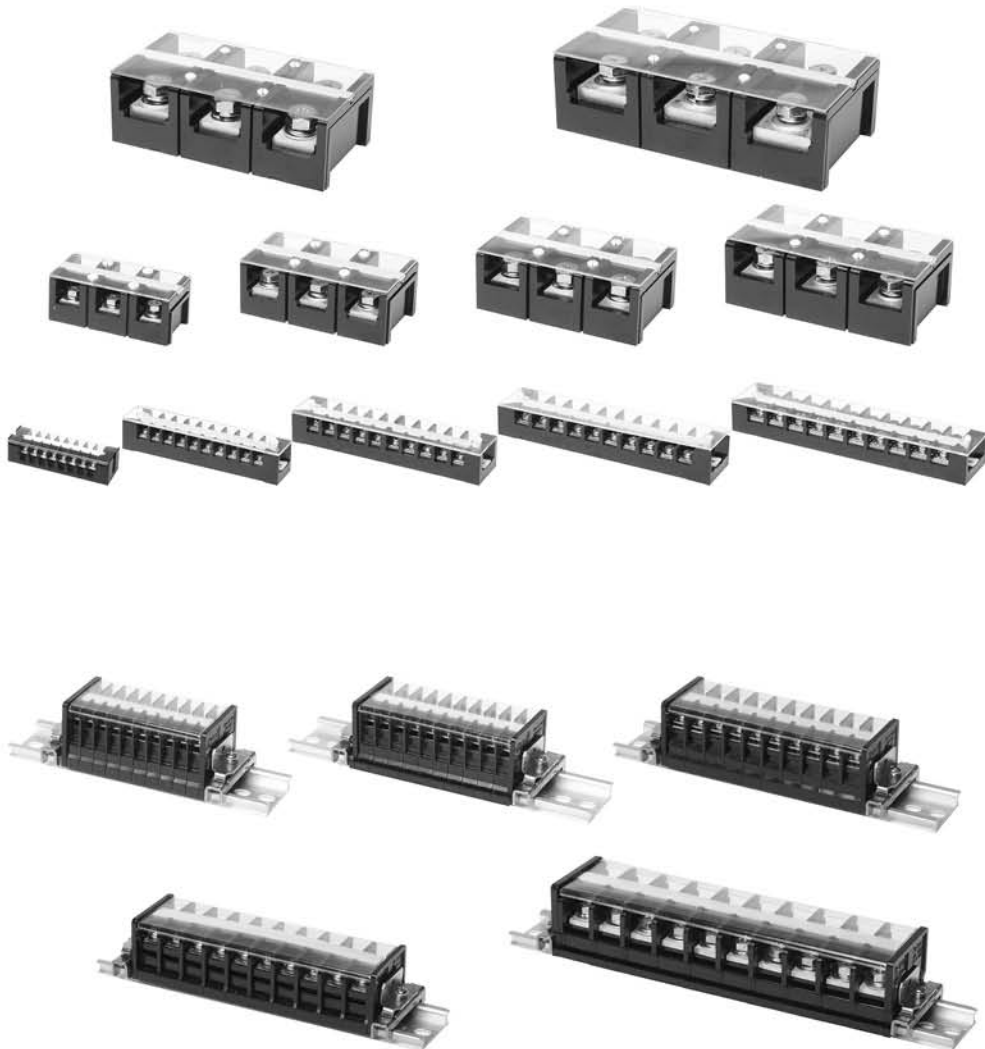

Quick Selection Guide

Type		Rated Current	No. of Poles	Model Number
Fixing Type	Normal	10A	10	KH-6010-10P
		20A	3	KH-6020-3P
		20A	4	KH-6020-4P
		20A	6	KH-6020-6P
		20A	8	KH-6020-8P
		20A	10	KH-6020-10P
		20A	12	KH-6020-12P
		20A	15	KH-6020-15P
		20A	20	KH-6020-20P
		30A	3	KH-6030-3P
		30A	4	KH-6030-4P
		30A	6	KH-6030-6P
		30A	10	KH-6030-10P
		45A	10	KH-6045-10P
		60A	3	KH-6060-3P
		60A	4	KH-6060-4P
		100A	3	KH-60100-3P
		100A	4	KH-60100-4P
		150A	3	KH-60150-3P
		200A	3	KH-60200-3P
		200A	4	KH-60200-4P
		300A	3	KH-60300-3P
		300A	4	KH-60300-4P
500A	3	KH-60500-3P		
500A	4	KH-60500-4P		
	Module Combination Type	25A	3~20	KTB25
	Common Terminal Type	15A	6	KH-6015-C
DIN rail Type	Single Level type (with Spring Clamp)	10A	-	KH-6110S
		15A	-	KH-6115S
		20A	-	KH-6120S
	Single Level type	30A	-	KH-6130
		60A	-	KH-6160
	Double level type	15A	-	KH-6215
Dual Type (Fixing Type/DIN rail Type)		100A	2	KH-65100-2P
		100A	3	KH-65100-3P
		100A	4	KH-65100-4P
		200A	2	KH-65200-2P
		200A	3	KH-65200-3P
		200A	4	KH-65200-4P
		350A	2	KH-65350-2P
		350A	3	KH-65350-3P
		350A	4	KH-65350-4P

CONTROL COMPONENTS

SQUARE LIGHT

TOWER LIGHT

MICRO SWITCH

FOOT SWITCH

LIMIT SWITCH

POWER SWITCH

HOIST SWITCH

CAM SWITCH

BUZZER

PHOTO SENSOR

PROXIMITY SENSOR

FLOATLESS LEVEL SWITCH

TIMER & COUNTER

RELAY

SOCKETS

TERMINAL BLOCK

CONTROL BOX

PID TEMP. CONTROLLER

KTB25 Module Combination Type

- Easily combine 3P and 4P bodies to make 3P ~ 20P terminal block.
(see next page.)

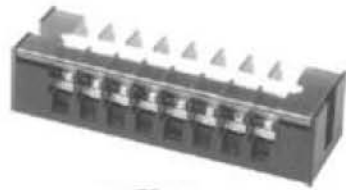

KTB25

Specification

Model	KTB25
Rated Voltage	600V
Rated Current	25A(250V)
Insulation Resistance	100MΩ min.
Dielectric Strength	2,500 VAC for 1min.
Ambient Temp.	-20~+55°C
Terminal Screw	M4
Fixing Screw	M4
Material	Nylon Glass

If Longer than 20P

Using elongation fixing unit, can make 20P~50P terminal block.

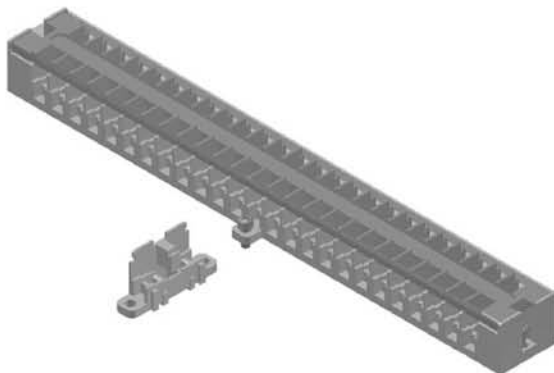

KTB25 Module Combination Type

Combination Example (10P)

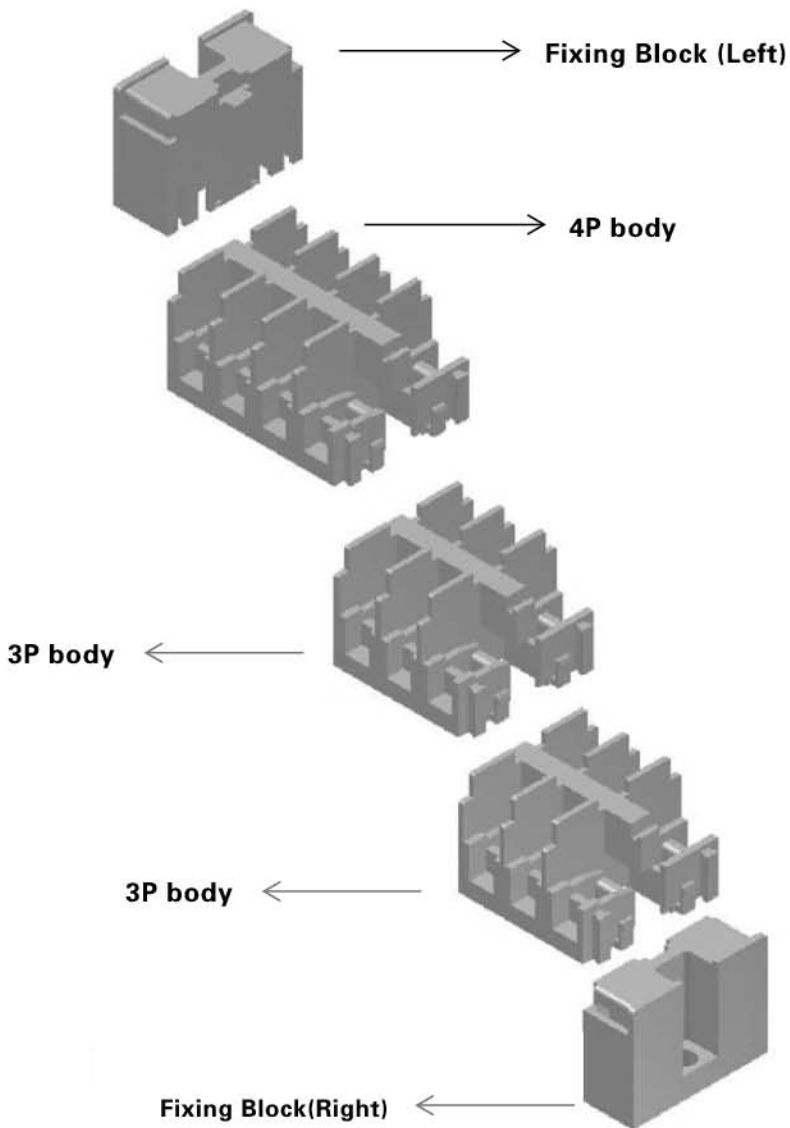

CONTROL COMPONENTS

SQUARE LIGHT

TOWER LIGHT

MICRO SWITCH

FOOT SWITCH

LIMIT SWITCH

POWER SWITCH

HOIST SWITCH

CAM SWITCH

BUZZER

PHOTO SENSOR

PROXIMITY SENSOR

FLOATLESS LEVEL SWITCH

TIMER & COUNTER

RELAY

SOCKETS

TERMINAL BLOCK

CONTROL BOX

PID TEMP. CONTROLLER

Fixing Type Terminal Blocks



KH-6010



KH-6020



KH-6030



KH-6045



KH-6060



KH-60100



KH-60150



KH-60200



KH-60300



KH-60500

Fixing Type Terminal Blocks

Wiring Rug

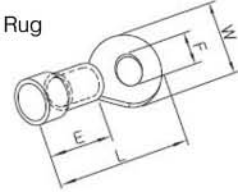

Specification

Model		KH-6010	KH-6020	KH-6030	KH-6045	KH-6060
Rated Voltage		600V				
Rated Current		10A(250V)	20A(250V)	30A(250V)	45A(250V)	60A(250V)
Insulation Resistance		100MΩ min.				
Dielectric Strength		2,500 VAC for 1min.				
Wire		2mm ²	3.5mm ²	5.5mm ²	8mm ²	22mm ²
Terminal Screw		M3	M4	M4.5	M5	M6
Wiring Rug	E	10.0mm	10.0mm	14.5mm	14.5mm	14.5mm
	F	Φ 3.1	Φ 4.1	Φ 4.6	Φ 5.1	Φ 6.1
	W	6.8mm	8.3mm	9.8mm	12mm	16.8mm
	L	20.6mm	21.5mm	26.5mm	26.5mm	35.5mm
Material	Body	Phenol				
	Cover	ABS(transparent)				
	Terminal	Brass				
	Plate	PVC(white)				

Model		KH-60100	KH-60150	KH-60200	KH-60300	KH-60500
Rated Voltage		600V				
Rated Current		100A(250V)	150A(250V)	200A(250V)	300A(250V)	300A(250V)
Insulation Resistance		100MΩ min.				
Dielectric Strength		2,500 VAC for 1min.				
Wire		38mm ²	60mm ²	100mm ²	150mm ²	200mm ²
Terminal Screw		M8	M10	M10	M12	M12
Wiring Rug	E	20.5mm	20.5mm	20.5mm	25.5mm	30.0mm
	F	Φ 8,1	Φ 10.1	Φ 10.1	Φ 12.2	Φ 12.2
	W	22.3mm	22.3mm	28.9mm	36.5mm	44.5mm
	L	45.5mm	45.5mm	50.5mm	55.5mm	65.5mm
Material	Body	Phenol				
	Cover	ABS(transparent)				
	Terminal	Brass				
	Plate	PVC(white)				

CONTROL COMPONENTS

SQUARE LIGHT

TOWER LIGHT

MICRO SWITCH

FOOT SWITCH

LIMIT SWITCH

POWER SWITCH

HOIST SWITCH

CAM SWITCH

BUZZER

PHOTO SENSOR

PROXIMITY SENSOR

FLOATLESS LEVEL SWITCH

TIMER & COUNTER

RELAY

SOCKETS

TERMINAL BLOCK

CONTROL BOX

PID TEMP. CONTROLLER

Fixing Type Terminal Blocks

Dimensions (KH-6010~6045)

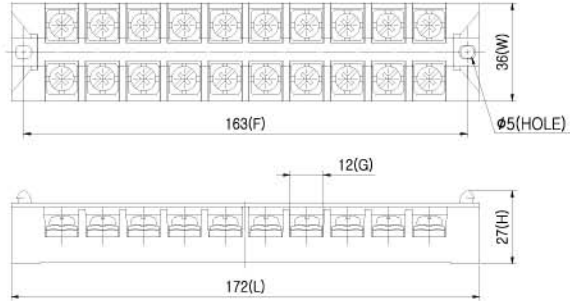

Model	Rating/Pole	F(mm)	G(mm)	Hole(Φ)	L(mm)	W(mm)	H(mm)	Weight
KH-6010-10P	10A 10P	104	7	5	113	23	27	27g
KH-6020-3P	20A 3P	45	8.5	5	54	30	27	47g
KH-6020-4P	20A 4P	57	8.5	5	66	30	27	58g
KH-6020-6P	20A 6P	80	8.5	5	89	30	27	82g
KH-6020-8P	20A 8P	103	8.5	5	112	30	27	103g
KH-6020-10P	20A 10P	127	8.5	5	136	30	27	127g
KH-6020-12P	20A 12P	151	8.5	5	160	30	27	152g
KH-6020-15P	20A 15P	187	8.5	5	196	30	27	185g
KH-6020-20P	20A 20P	242	8.5	5	251	30	27	245g
KH-6030-3P	30A 3P	50.8	10	5	60	33	27	63g
KH-6030-4P	30A 4P	64	10	5	73	33	27	77g
KH-6030-6P	30A 6P	90.4	10	5	100	33	27	110g
KH-6030-10P	30A 10P	144	10	5	156	33	27	172g
KH-6045-10P	45A 10P	163	12.2	5	171	36	27	235g

Fixing Type Terminal Blocks

Dimensions (KH-6060~60500)

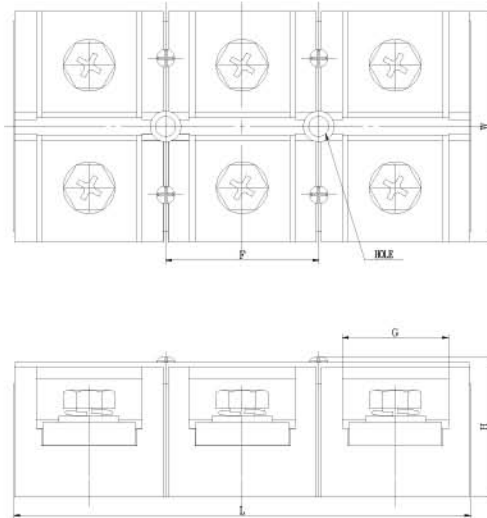

Model	Rating/Pole	F(mm)	G(mm)	Hole(Φ)	L(mm)	W(mm)	H(mm)	Weight
KH-6060-3P	60A 3P	28	16	5.2	85	40	36	142g
KH-6060-4P	60A 4P	57	16	5.2	113	40	36	190g
KH-60100-3P	100A 3P	35	23	6.5	105	56	41.5	300g
KH-60100-4P	100A 4P	70	23	6.5	140	56	41.5	406g
KH-60150-3P	150A 3P	38.5	22.5	7.2	116	68	45.5	499g
KH-60200-3P	200A 3P	45	28.8	7.2	135	73	49.5	591g
KH-60200-4P	200A 4P	90	28.8	7.2	180	73	49.5	796g
KH-60300-3P	300A 3P	52	37	8.5	155	83	54	939g
KH-60300-4P	300A 4P	104	37	8.5	208	83	54	1,278g
KH-60500-3P	500A 3P	65	45	8.5	194	97.5	59.5	1,615g
KH-60500-4P	500A 4P	130	45	8.5	260	97.5	59.5	2,163g

CONTROL COMPONENTS

SQUARE LIGHT

TOWER LIGHT

MICRO SWITCH

FOOT SWITCH

LIMIT SWITCH

POWER SWITCH

HOIST SWITCH

CAM SWITCH

BUZZER

PHOTO SENSOR

PROXIMITY SENSOR

FLOATLESS LEVEL SWITCH

TIMER & COUNTER

RELAY

SOCKETS

TERMINAL BLOCK

CONTROL BOX

PID TEMP. CONTROLLER

Fixing Type Terminal Blocks

Terminal Dimensions

KH-6010

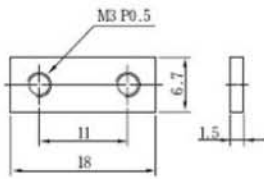

KH-6020

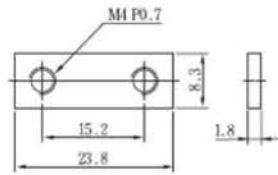

KH-6030

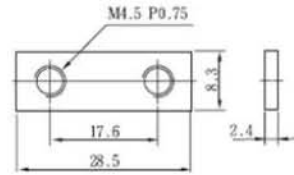

KH-6045

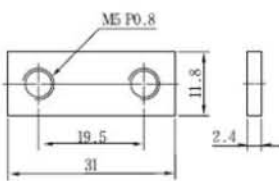

KH-6060

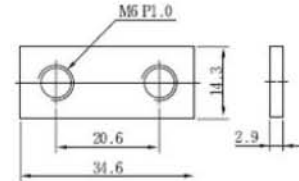

KH-60100

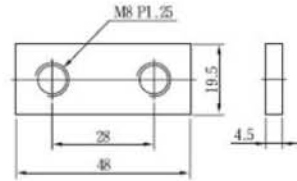

KH-60150

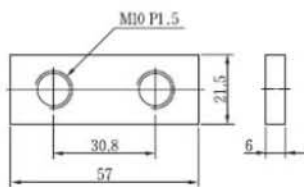

KH-60200

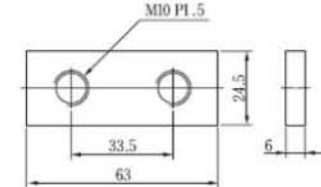

KH-60300

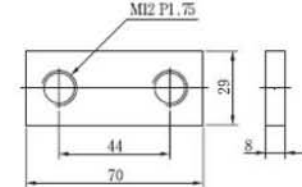

KH-60500

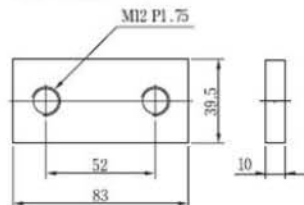

Terminal Blocks with Common Terminal

Specification

Model		KH-6015-C
Rated Voltage		600V
Rated Current		15A(250V)
Insulation Resistance		100MΩ min.
Dielectric Strength		2,500 VAC for 1min.
Wire		8mm ²
Terminal Screw		M5
Wiring Rug	E	10.0mm
	F	Φ 5.1
	W	12.7mm
	L	23.0mm
Material	Body	Phenol
	Terminal	Brass
Material	Plate	PVC(white)
Weight		270g

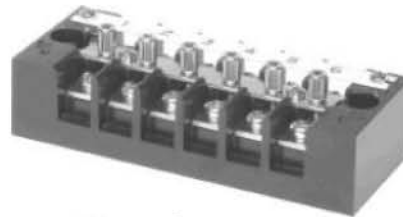

KH-6015C

Wiring Rug

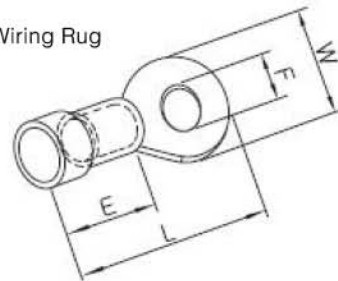

Dimensions

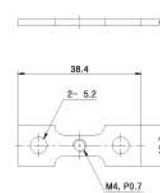
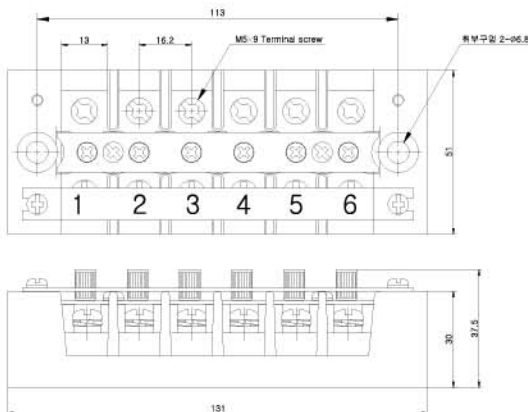

CONTROL COMPONENTS

SQUARE LIGHT

TOWER LIGHT

MICRO SWITCH

FOOT SWITCH

LIMIT SWITCH

POWER SWITCH

HOIST SWITCH

CAM SWITCH

BUZZER

PHOTO SENSOR

PROXIMITY SENSOR

FLOATLESS LEVEL SWITCH

TIMER & COUNTER

RELAY

SOCKETS

TERMINAL BLOCK

CONTROL BOX

PID TEMP. CONTROLLER

DIN-rail type KH-6110S, KH-6115S



KH-6110S



KH-6115S

Specification

Model		KH-6110S	KH-6115S
Rated Voltage		600V	
Rated Current		10A(250V)	15A(250V)
Insulation Resistance		100MΩ min.	100MΩ min.
Dielectric Strength		2,500 VAC for 1min.	
Wire		1.25mm ²	2mm ²
Terminal Screw		M3	M3.5
Wiring Rug	E	10.0mm	10.0mm
	F	Φ3.1	Φ3.6
	W	5.7mm	6.7mm
	L	21.0mm	21.0mm
Material	Body	Noryl	
	Cover	PC (transparent)	
	Terminal	Brass	
	Plate	PVC (white)	
Weight	Weight	6.5g	7.7g

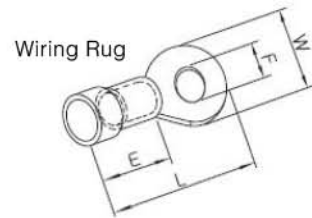

Dimensions

Model	A	B	C	D	E	F	G	H
KH-6110S	5.7	1	24	M3	7X(N-1)+60	7X(N-1)+13	37.5	39
KH-6115S	6.6	1	25	M3.5	8X(N-1)+61	8X(N-1)+14	37.5	39

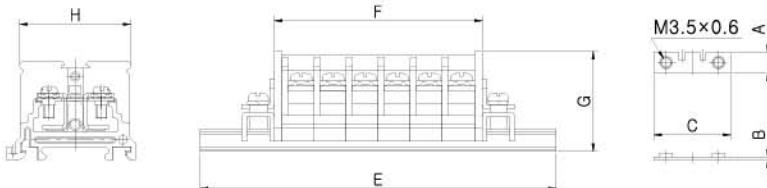

DIN-rail type KH-6120S



KH-6120S

Specification

Model		KH-6120S
Rated Voltage		600V
Rated Current		20A(250V)
Insulation Resistance		100MΩ min.
Dielectric Strength		2,500 VAC for 1min.
Wire		3.5mm ²
Terminal Screw		M4
Wiring Rug	E	14mm
	F	Φ4.1
	W	8.3mm
	L	27.0mm
Material	Body	PC
	Cover	PC (transparent)
	Terminal	Brass
	Plate	PVC (white)
Weight		12g

Wiring Rug

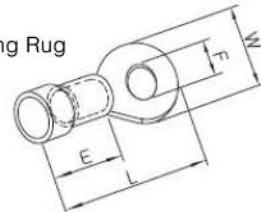

Dimensions

Model	A	B	C	D	E	F	G	H
KH-6120S	8.5	1.6	27.5	M4	10.5X(N-1)+63	10.5X(N-1)+16	37.5	39

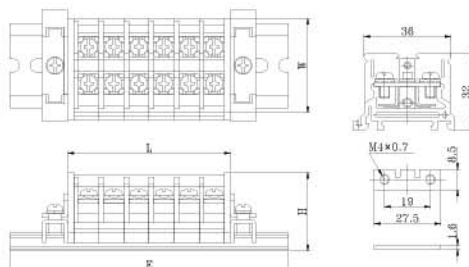

CONTROL COMPONENTS

SQUARE LIGHT

TOWER LIGHT

MICRO SWITCH

FOOT SWITCH

LIMIT SWITCH

POWER SWITCH

HOIST SWITCH

CAM SWITCH

BUZZER

PHOTO SENSOR

PROXIMITY SENSOR

FLOATLESS LEVEL SWITCH

TIMER & COUNTER

RELAY

SOCKETS

TERMINAL BLOCK

CONTROL BOX

PID TEMP. CONTROLLER

DIN-rail type KH-6130, 6160



KH-6130



KH-6160

Specification

Model		KH-6130	KH-6160
Rated Voltage		600V	
Rated Current		30A(250V)	60A(250V)
Insulation Resistance		100MΩ min.	
Dielectric Strength		2,500 VAC for 1min.	
Wire		5.5mm ²	14mm ²
Terminal Screw		M4.5	M6
Wiring Rug	E	14.0mm	14.5mm
	F	Φ4.6	Φ6.1
	W	9.8mm	13.6mm
	L	27.0mm	30.0mm
Material	Body	PC (black)	
	Cover	PC (transparent)	
	Terminal	Brass	
	Plate	PVC (white)	
Weight		15g	31g

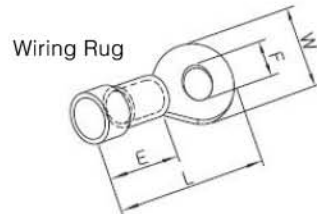

Dimensions

Model	A	B	C	D	E	F	G	H
KH-6130	9.8	2.4	28.5	M4.5	12.5X(N-1)+65	12.5X(N-1)+18	35.5	39
KH-6160	14.5	3.0	35.0	M6	17X(N-1)+70	17X(N-1)+24	41.5	45

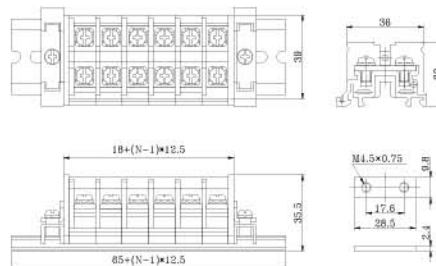

Double Level DIN-rail type KH-6215

Specification

Model		KH-6215
Rated Voltage		600V
Rated Current		15A(250V)
Insulation Resistance		100MΩ min.
Dielectric Strength		2,500 VAC for 1min.
Wire		2.0mm ²
Terminal Screw		M3.5
Wiring Rug	E	10.0mm
	F	Φ3.6
	W	6.8mm
	L	21.0mm
Material	Body	PC
	Cover	PC (transparent)
	Terminal	Brass
	Plate	PVC (white)
Weight		21g



KH-6215

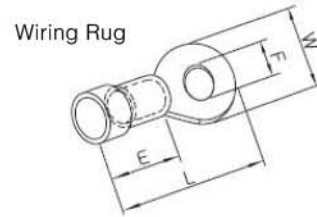

Wiring Rug

Dimensions

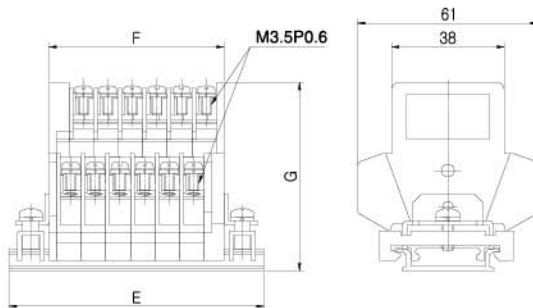

Model	E	F	G
KH-6215	8.3X(N-1)+66	8.3X(N-1)+18	63

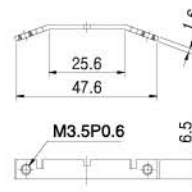
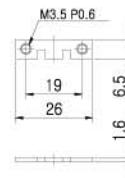

CONTROL COMPONENTS

SQUARE LIGHT

TOWER LIGHT

MICRO SWITCH

FOOT SWITCH

LIMIT SWITCH

POWER SWITCH

HOIST SWITCH

CAM SWITCH

BUZZER

PHOTO SENSOR

PROXIMITY SENSOR

FLOATLESS LEVEL SWITCH

TIMER & COUNTER

RELAY

SOCKETS

TERMINAL BLOCK

CONTROL BOX

PID TEMP. CONTROLLER

Dual type KH-65100, 65200, 65350



Can select Surface mounting / DIN rail mounting

Specification

Model		KH-65100	KH-65200	KH-65350
Rated Voltage		600V		
Rated Current		100A(250V)	200A(250V)	350A(250V)
Insulation Resistance		100M Ω min.		
Dielectric Strength		2,500 VAC for 1min.		
Wire		38mm ²	60mm ²	100mm ²
Terminal Screw		M8	M10	M12
Wiring Rug	E	12.5mm	17.5mm	18.5mm
	F	Φ 8.4	Φ 10.5	Φ 13.0
	W	22mm	22mm	28.5mm
	L	43mm	50mm	56mm
Material	Body	Noryl (black)		
	Cover	PC (transparent)		
	Terminal	Brass		
	Plate	PC (white)		
Weight		71g	149g	248g

Dual type KH-65100, 65200, 65350

Dimensions

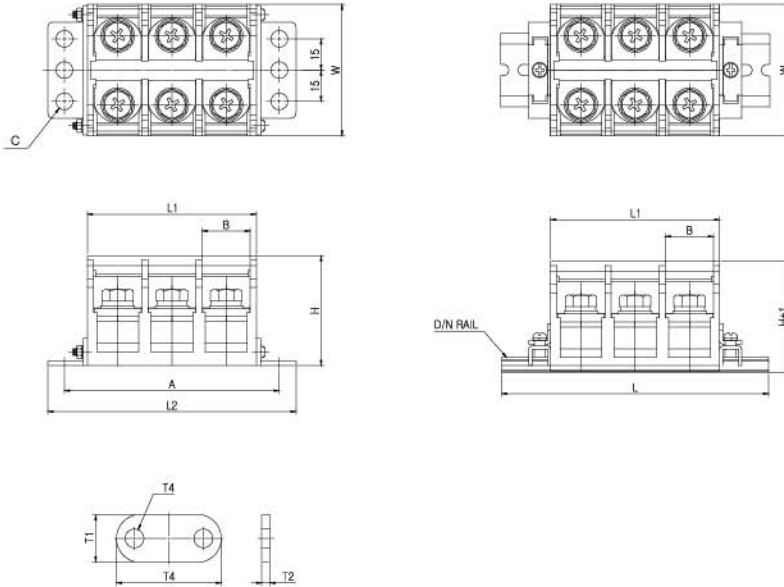

Model	A	B	ΦC	L1	L2	W	H	T1	T2	T3	T4
KH-65100-2P	77	23	8	55	93	63	52.5	22.5	4	50.2	9
KH-65100-3P	103	23	8	81	119	63	52.5	22.5	4	50.2	9
KH-65100-4P	129	23	8	107	145	63	52.5	22.5	4	50.2	9
KH-65200-2P	100	33	8	78	116	90	61	32.5	4	67.8	10.8
KH-65200-3P	137	33	8	115	153	90	61	32.5	4	67.8	10.8
KH-65200-4P	174	33	8	152	190	90	61	32.5	4	67.8	10.8
KH-65350-2P	142	52	8	119	158	120	75	50.8	4	90	13
KH-65350-3P	199	52	8	176	215	120	75	50.8	4	90	13
KH-65350-4P	256	52	8	233	272	120	75	50.8	4	90	13

CONTROL COMPONENTS

SQUARE LIGHT

TOWER LIGHT

MICRO SWITCH

FOOT SWITCH

LIMIT SWITCH

POWER SWITCH

HOIST SWITCH

CAM SWITCH

BUZZER

PHOTO SENSOR

PROXIMITY SENSOR

FLOATLESS LEVEL SWITCH

TIMER & COUNTER

RELAY

SOCKETS

TERMINAL BLOCK

CONTROL BOX

PID TEMP. CONTROLLER

DIN rail KH-TBR-2 & Stopper

KH-TBR-2



- Material: Aluminum
- 1M & 2M available

Dimensions

TERMINAL BLOCK RAIL

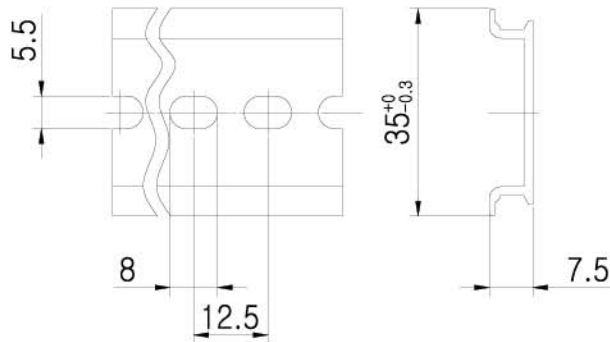

Stopper



- Material: Steel
- Use at two ends of DIN rail attached terminal blocks

▼
Creative Passion

Koino[®]

www.koino.com

▼
Creative Passion

Koino[®]

www.koino.com